

A close-up photograph of a person's hand pointing at a map or technical drawing spread out on a table. The person is wearing a dark blue jacket. The map shows various lines and text, likely representing a project plan or site layout. The background is slightly blurred, showing other people and the table surface.

Lower Thames Crossing

Lower Thames Crossing Task Force

What we'll cover

- Summary of changes in the last year
- Current engagement
- Programme



Changes in the last year



Changes to Tilbury Fields

- Improved access to the riverfront
- Access to more recreational routes
- Increased mosaic habitat

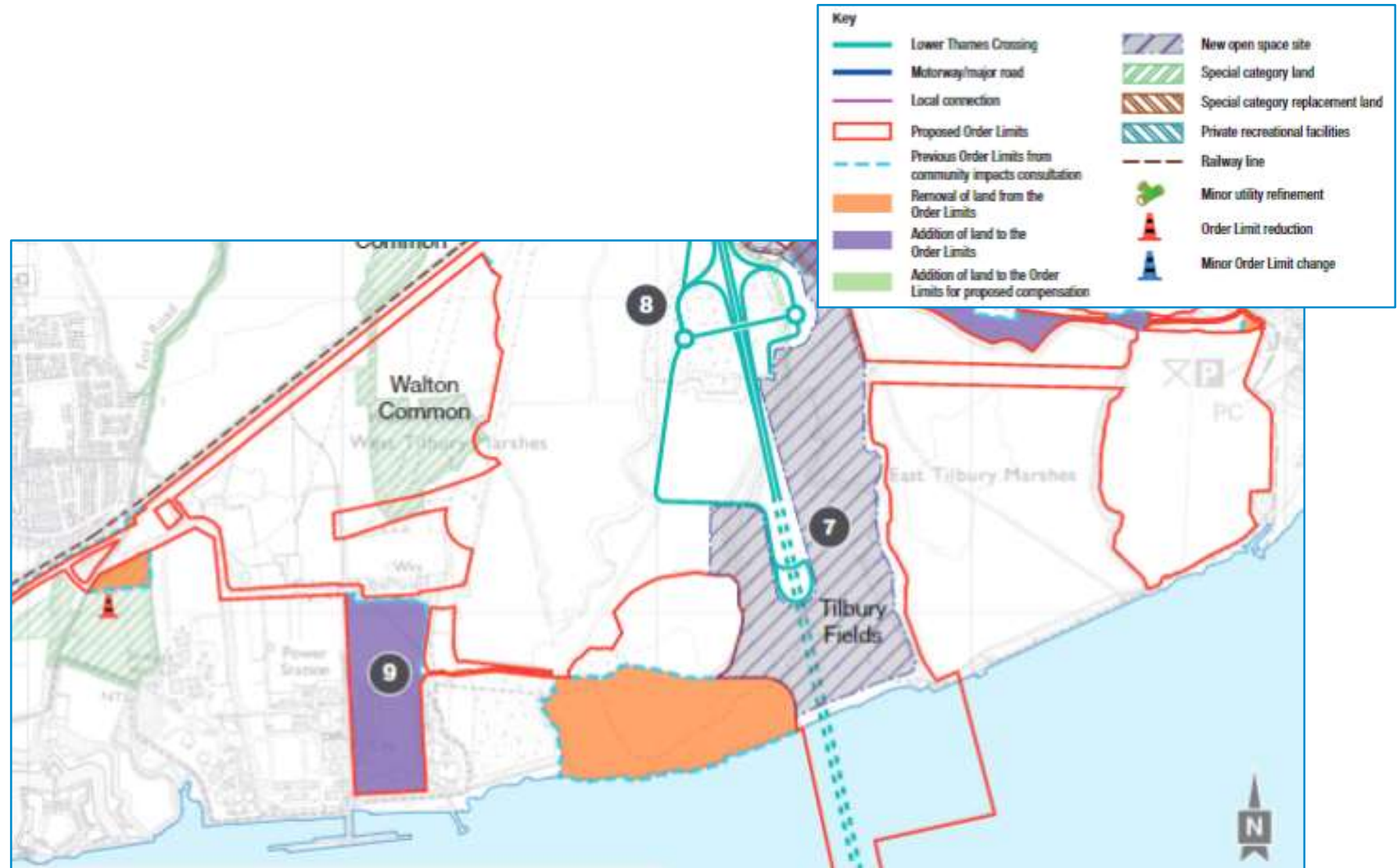

Proposed northern tunnel entrance approach, looking south



A new link road from the Orsett Cock junction to the southbound A1089

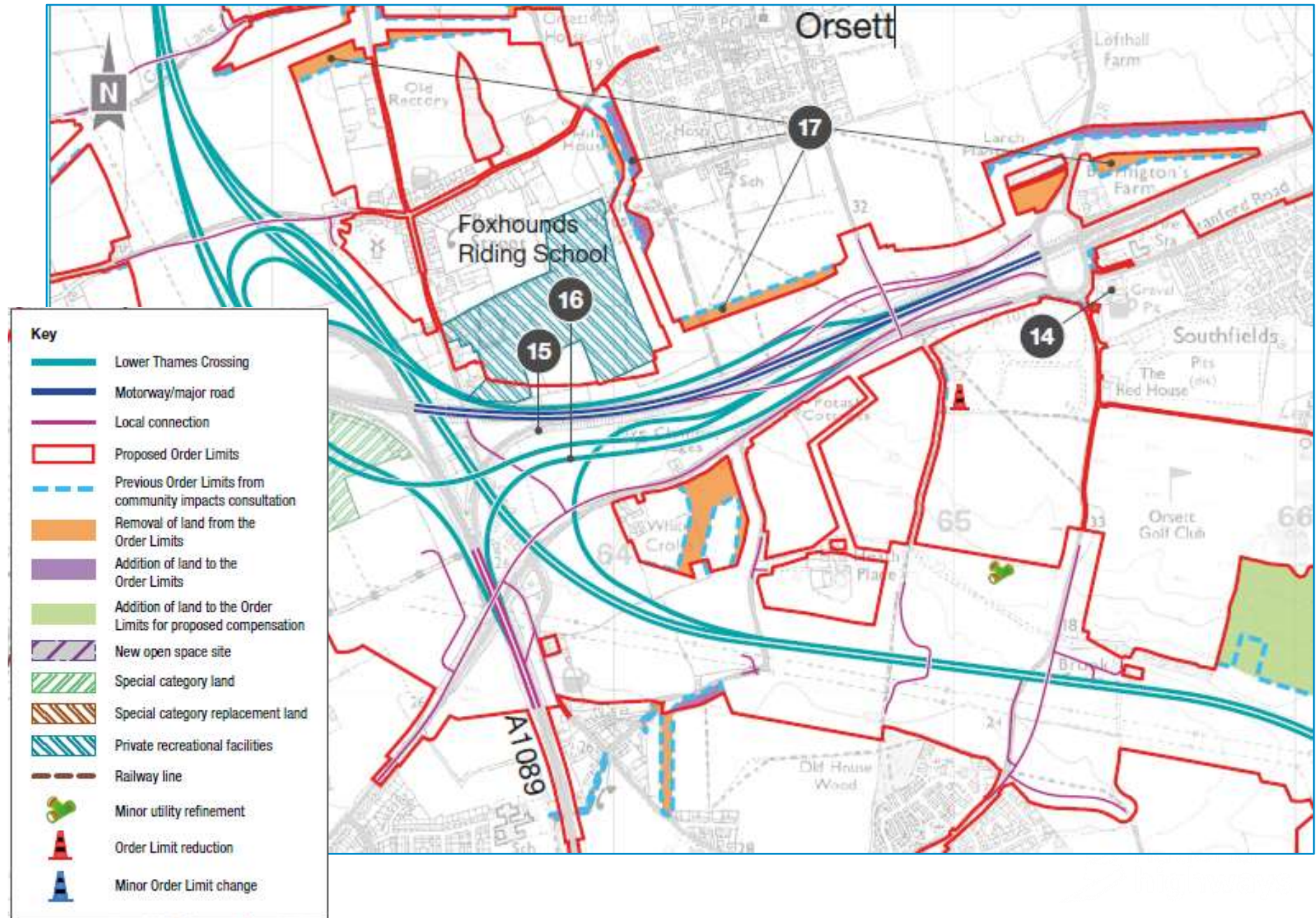

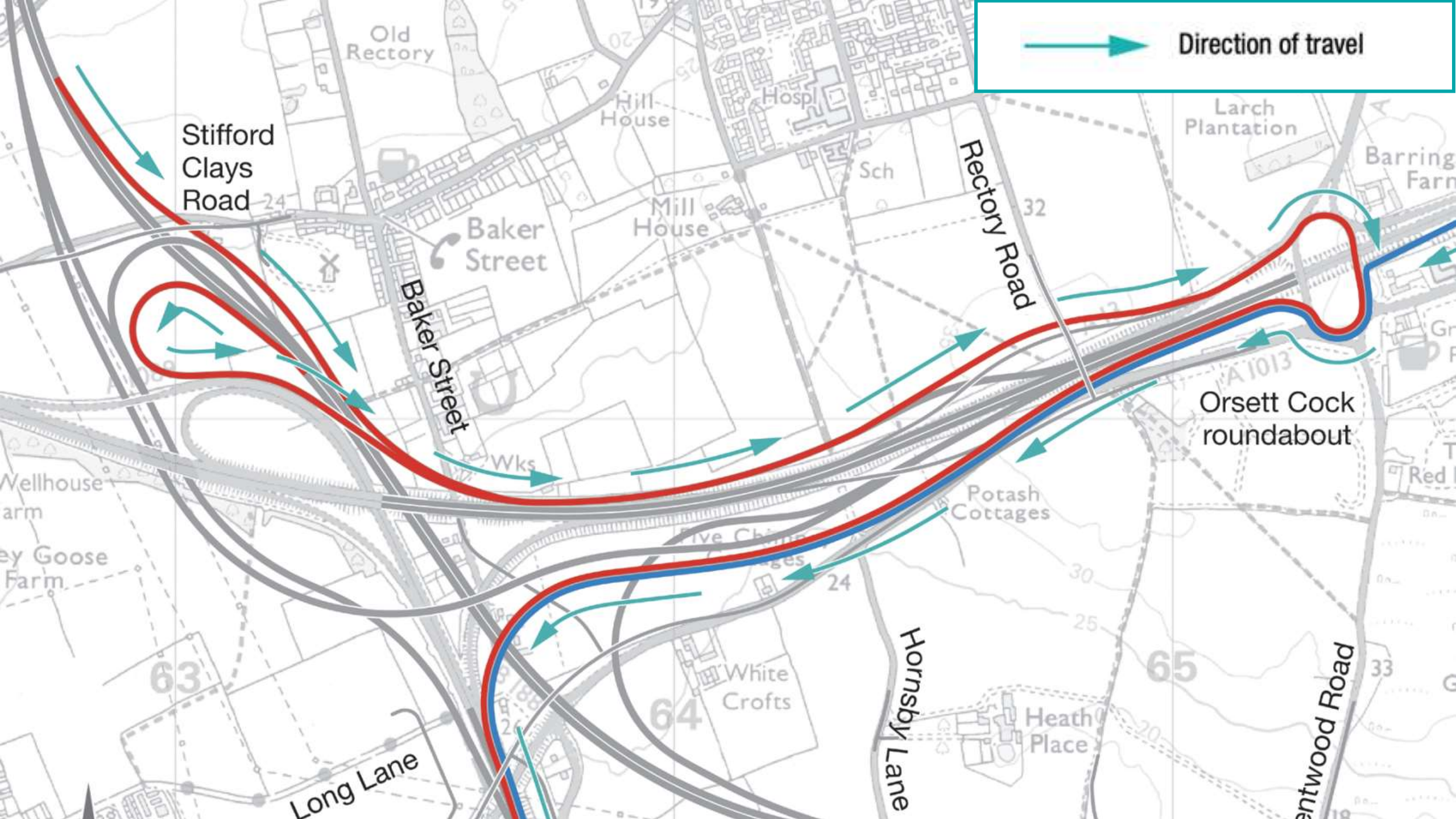

→ Direction of travel

Stifford Clays Road

Old Rectory

Hill House

Hospl

Larch Plantation

Barring Farm

Baker Street

Baker Street

Mill House

Rectory Road

Orsett Cock roundabout

Wellhouse arm

ey Goose Farm

Wks

Potash Cottages

Five Ch...

63

64

White Crofts

24

Hornby Lane

30

25

65

Heath Place

Long Lane

entwood Road

33

Proposed landscaping A13/A1089 junction

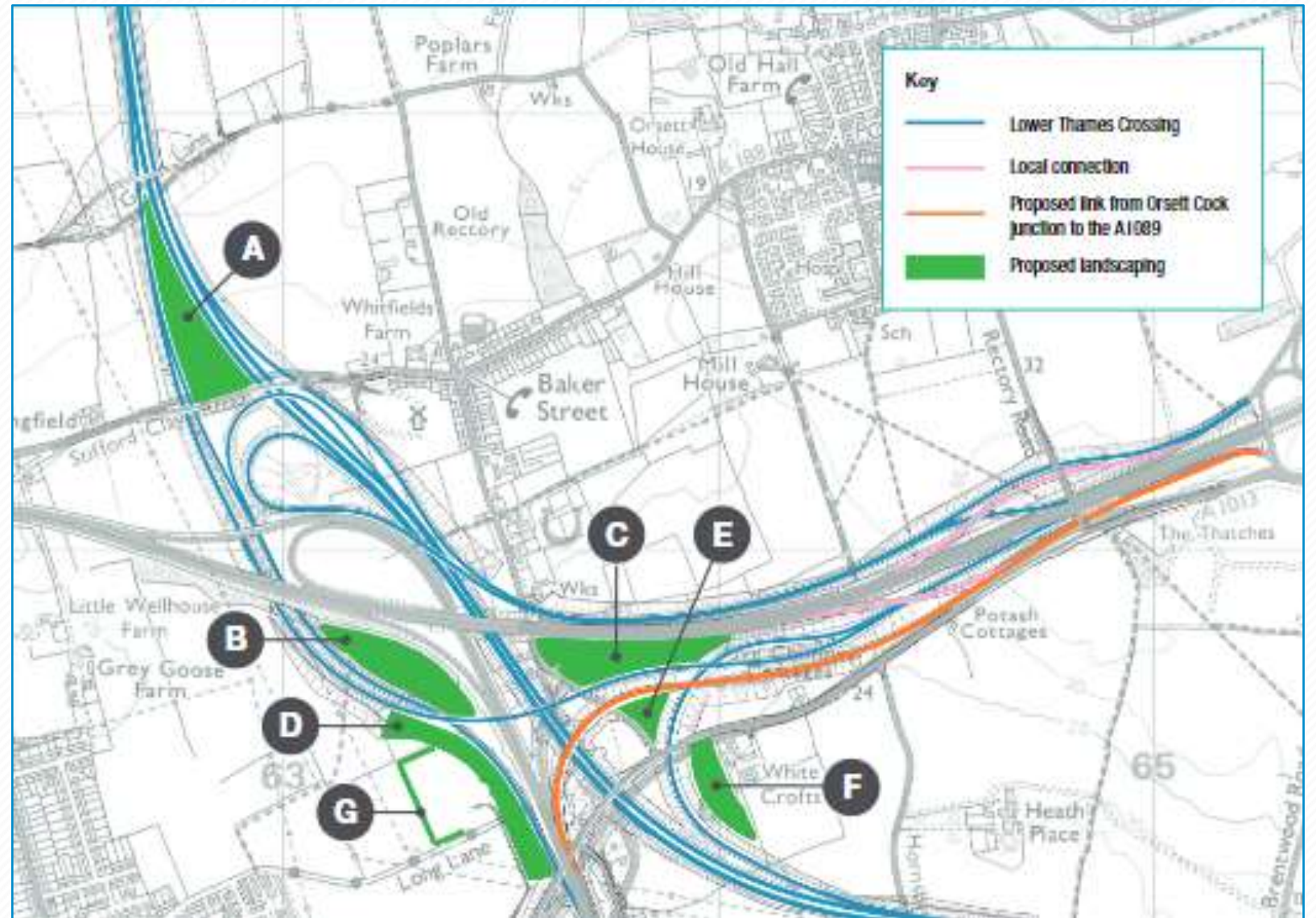

Proposed view of A13 / A1089 looking south



Walkers, cyclists and horse riders

Some of the proposals are:

- A new footbridge and bridleway over the M25
- Rectory Road bridge over the A13 to be replaced with a wider bridge
- Four new green bridges
- Improved connections and restoration between the local community and heritage sites
- A new foot and cycle path between East Tilbury, Linford and Chadwell St Mary.



New footpaths to link the heritage assets of Coalhouse Fort, Coalhouse Battery and Bowaters Battery to East Tilbury

Redesign of Tilbury Fields to provide link from BR58 (Coal Road) to FP200



**Bridleway
BR219
realignment
along Mardyke
river.**

**FP136 to be
upgraded to
bridleway**

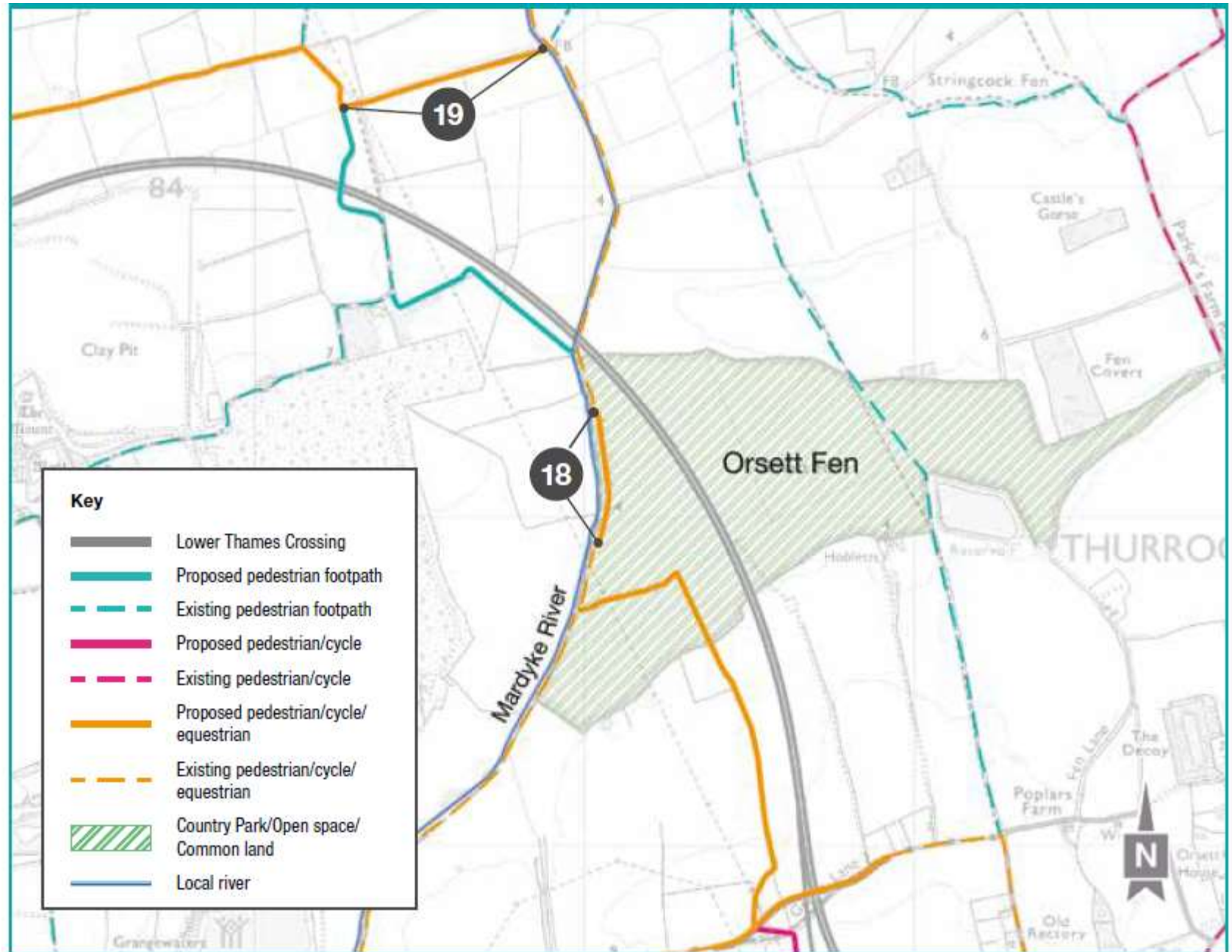

Nitrogen deposition and proposals for mitigation and compensation



Proposed compensation area in Thurrock

Figure 5-6: Proposed compensation land located in Thurrock

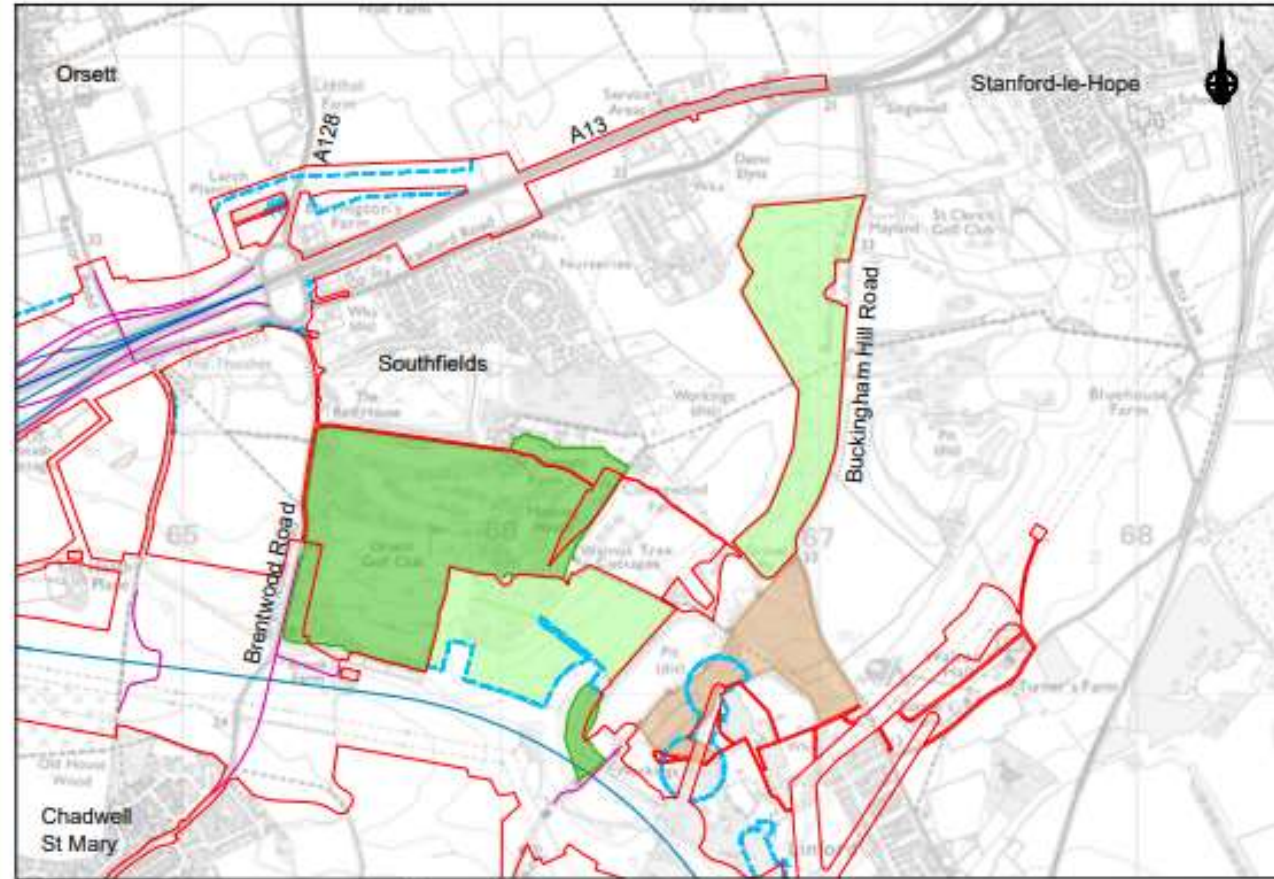

KEY

- Lower Thames Crossing (LTC)
- Motorway/major road
- Local connection
- Proposed Order Limits

- Previous Order Limits from community impacts consultation
- Addition of land to the Order Limits for proposed compensation

- Designated sites - no significant effects
- Designated sites - potential significant effects

**Smaller changes and
refinements**

Refinements to a route of a gas pipeline diversion around Orsett



A Additional land added to complete works on existing gas pipeline.

Removal of proposed Dock Road water connection

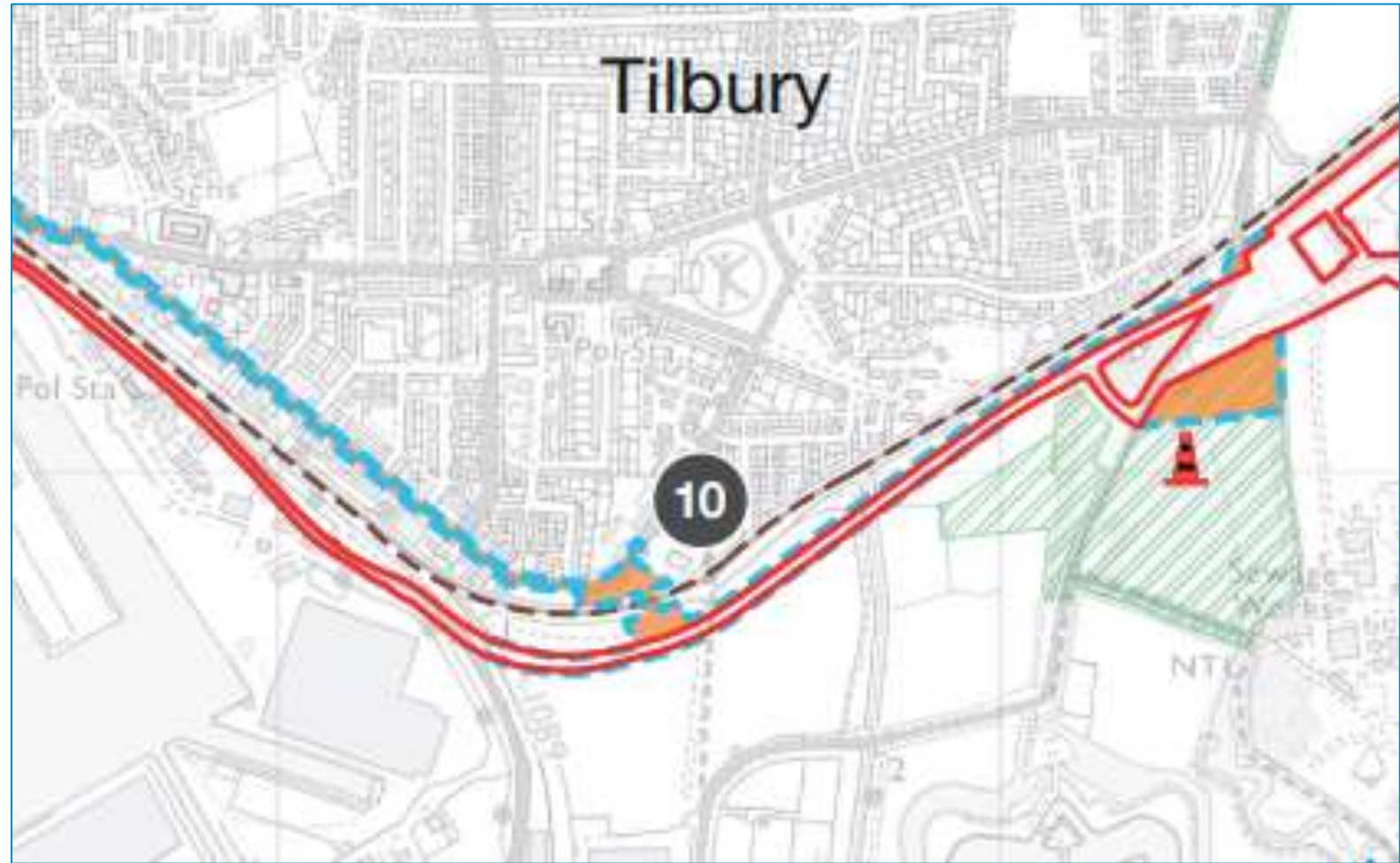

**Coopers Shaw
Road water
connection
refinement**

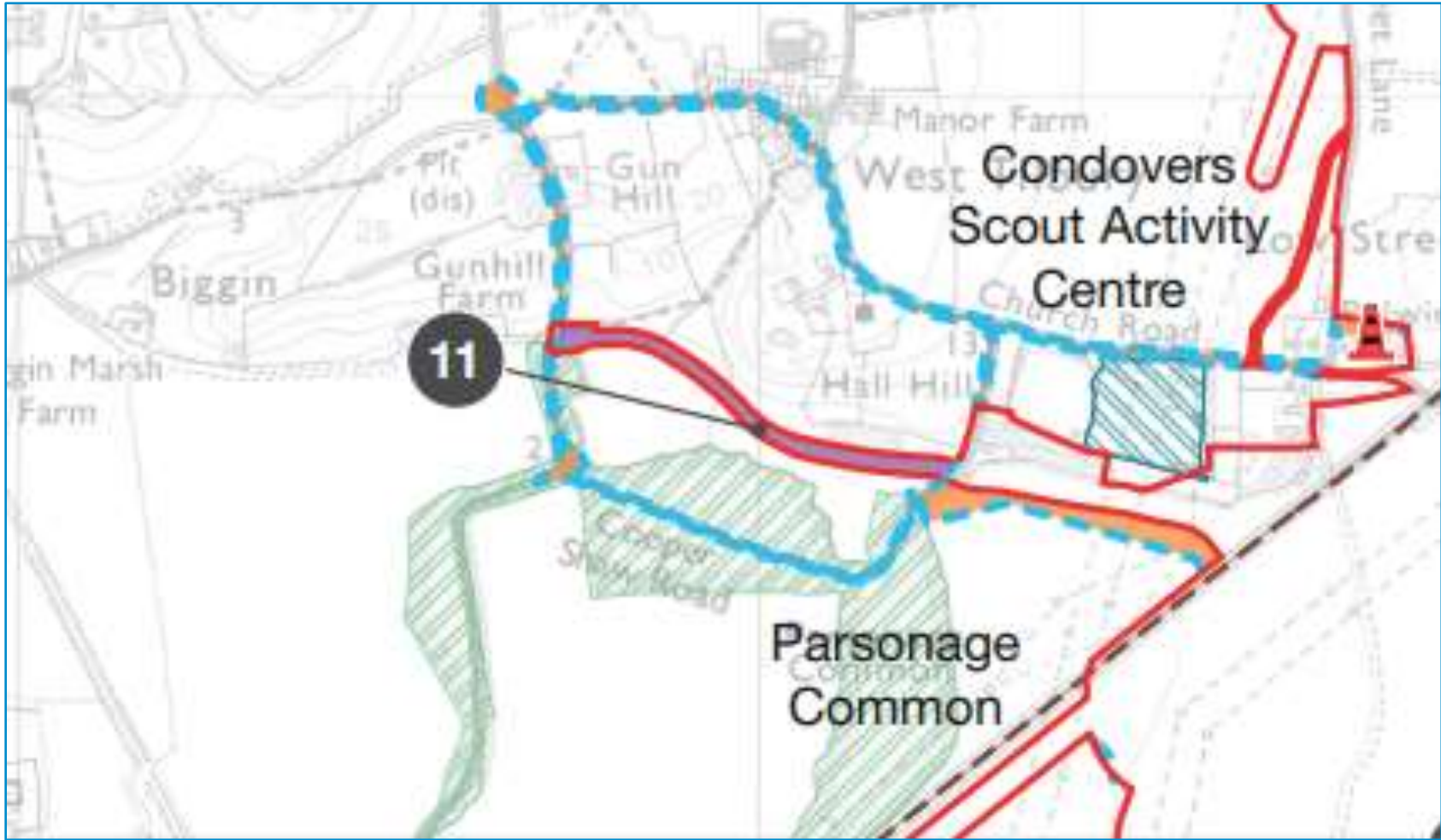

Proposed Order Limits – whole route

Order Limits at the 2021 community impacts consultation

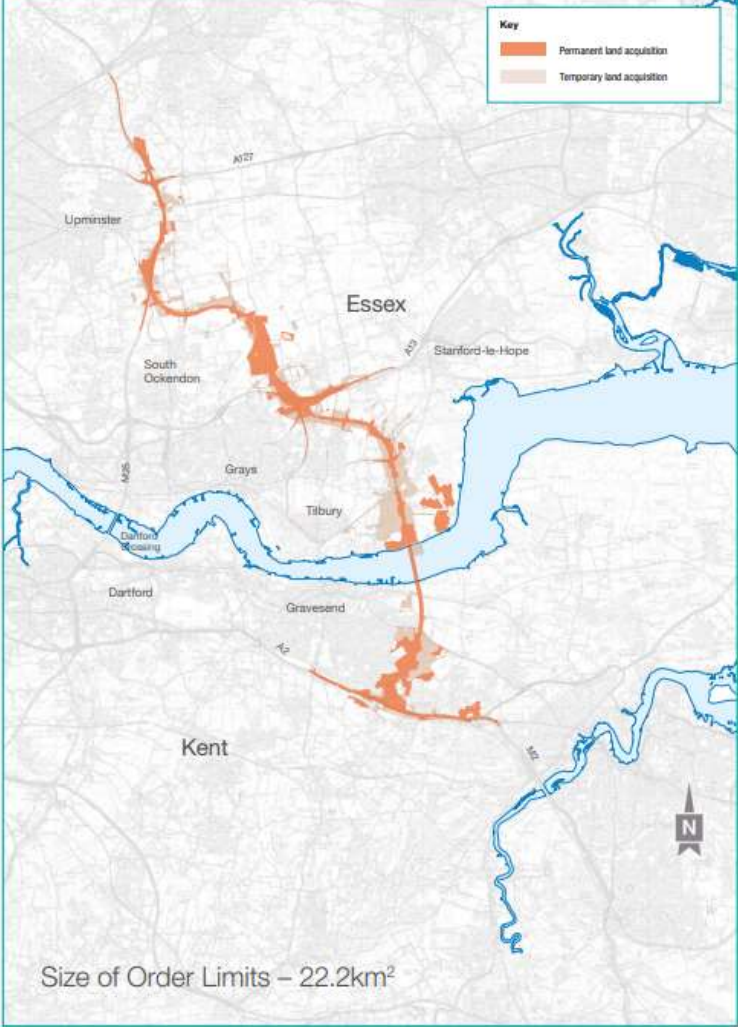

Proposed land acquisition at the 2022 local refinement consultation

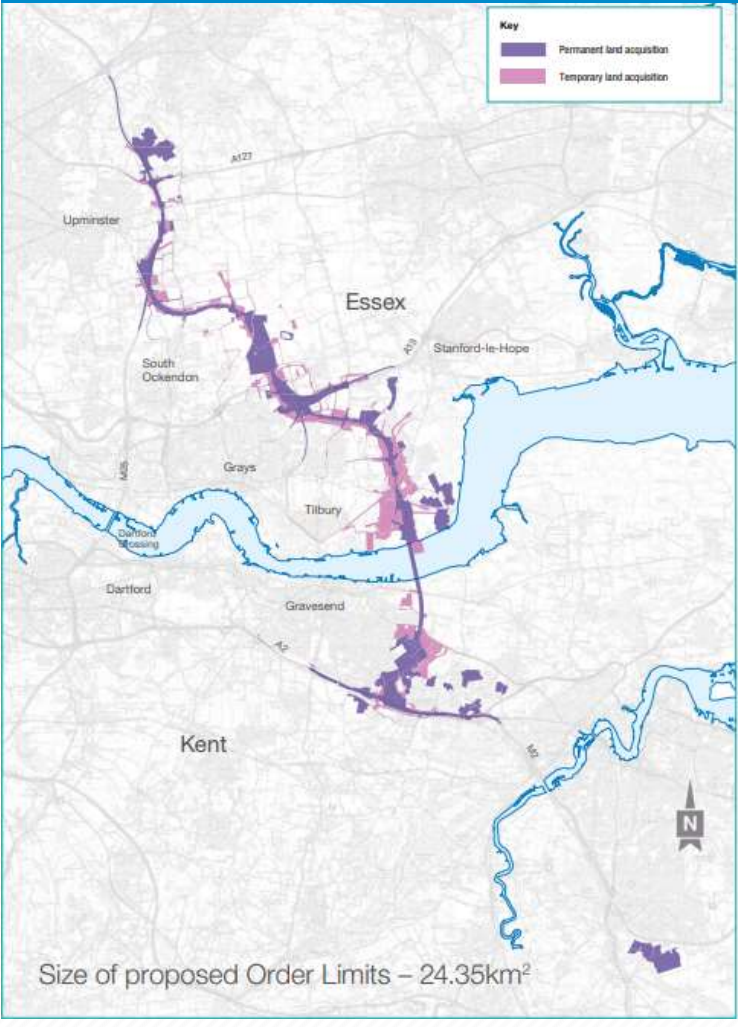

Changes to the proposed Order Limits at the 2022 local refinements consultation

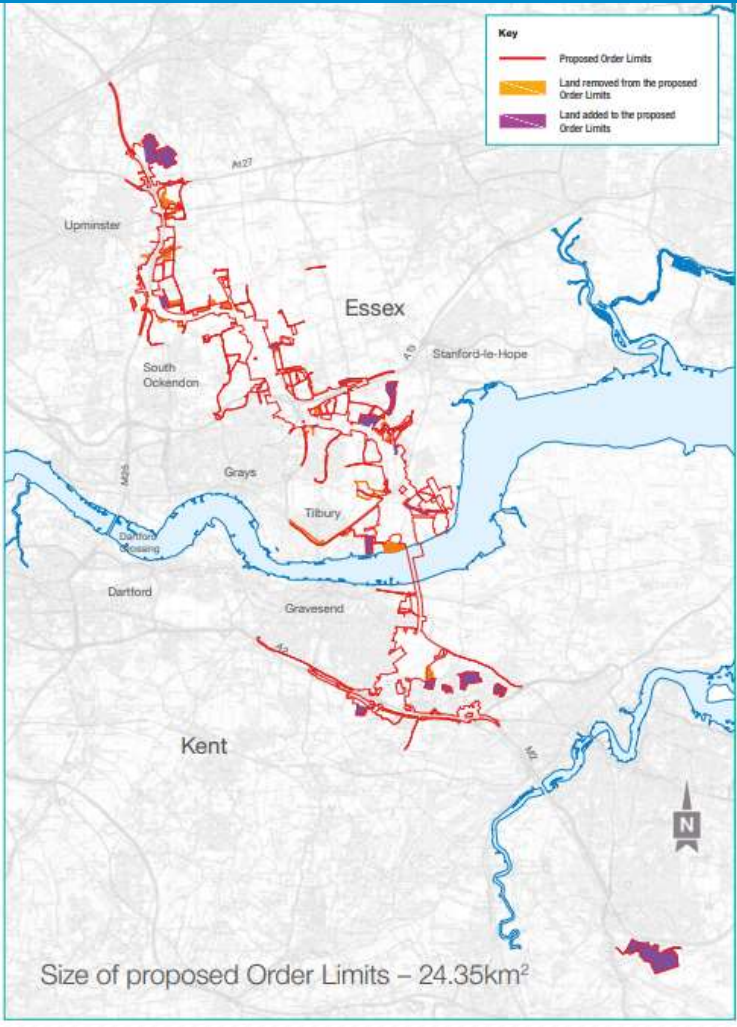

Current Engagement



Current engagement

Meetings with the Council and Topics Covered	
Procedural Matters	<ul style="list-style-type: none">• Fortnightly catch-up meetings
Regular Topic Specific Meetings	<ul style="list-style-type: none">• Hatch meetings• Wider Network Impacts meetings• Traffic Modelling catch-ups• Climate and Decarbonisation meetings• Construction Traffic Impacts meetings• S106 Agreement discussions• Land and Property meetings
Strategic Discussions and Additional Technical Meetings	<ul style="list-style-type: none">• Meetings to discuss the draft SoCG and key issues• Senior Strategic discussions• Senior Forum meetings• Meetings to discuss outstanding comments on the draft DCO• Nitrogen Deposition Methodology briefing
Cross Local Authority Discussions	<ul style="list-style-type: none">• Local Authority Carbon update• Tilbury Fields meetings• Environmental Briefings on ES Topics• Benefits Steering Group

Current engagement

Progress in 2022

- **Responses to Issues raised by the Council:** National Highways agreed a list of key issues of concern with Thurrock Council officers and have shared all (577) responses with the Council. NH have also shared responses on a further 928 issues with the Council and have also clarified responses on approx. 1300 issues which have been superseded or duplicated.
- **Statement of Common Ground (SoCG):** The list of key issues and responses formed the basis of the Thurrock Council SoCG. LTC and Thurrock Council have worked closely to develop the SoCG and to resolve specific issues in dedicated meetings (construction traffic impacts and Hatch meetings). LTC and Thurrock Council have held 3 all-day workshops to jointly review the issues and wording in the SoCG. The document has now been issued to Thurrock Council for their review.
- **Community Fund and S106 Meetings:** We have undertaken meetings to develop proposals around the LTC Community Fund and to discuss the S106 Heads of Terms proposed for inclusion. The meetings have also been used to discuss commitments from the SEE Strategy and the Community Fund.

Current engagement

Progress in 2022

- **Environmental Briefings:** We have organised a series of Environmental Briefings to share changes since DCO Version 1 including the project's approach for mitigation and compensation.
- **Traffic Modelling Exercises and Outputs:** Detailed modelling exercises have been undertaken to assist with the understanding of traffic impacts at local junctions. National Highways has completed the operational and construction traffic models and shared the model results with Local Authorities. National Highways will continue to support local authorities with their requested additional modelling requests to support the development of their position relating to the project.
- **Local Authority Carbon Briefing:** An additional session to cover carbon matters and to provide an overview of all carbon commitments contained in the DCO.
- **Tilbury Fields Workshops:** To discuss the proposed design of Tilbury Fields, which included proposed mitigation proposals and a response to previous comments made on the design raised by the Council.

Current engagement

Key Areas of agreement (Hatch Measures)

- Ensuring a minimal level of disruption during construction by phasing activities, site working hours and locating compound sites away from properties and sensitive receptors
- Best practice approaches in relation to dust and emissions
- Ensuring clear waste management processes and mitigation measures during construction and operation
- Flood Risk mitigation and water quality improvements through SuDS
- Sustainable worker transport access for access to Project construction compounds
 - National Highways will use best endeavours to ensure that the shuttle buses used by the project will be zero emissions vehicles.
- Council-Led Community & Public Health Team and Transport Network Management & Development Resource
 - LTC is happy to support Thurrock with the resource they require post-consent and we are discussing the details.
- Improvements to cycling and footpath provision for the Two Forts Way
- Restoration of Belhus Wood

Current engagement

Key Areas of agreement (Hatch Measures)

- Improve the PRow Network
 - Including PRow proposals sought within the LTC DCO (BR58, FP200 and the link through the Ron Evans Memorial Ground) and developing further legacy proposals outside the DCO.
- Enhancement of key sites in close proximity of LTC as legacy projects including:
 - King George's Park (Daisy Field), Koala Park, Anchor Fields, Fielding Avenue, Orsett Heath & Chadwell Recreational Ground and Wickham Fields and Blackshots.
- Provision of internet and 5G cables within the alignment and use of best-in-class energy efficient systems for its operations
- Compensation for properties & businesses and business rates holidays for firms affected during construction
- Provision of low-noise road surfacing on the Project
- Support to enable community engagement during the construction of the LTC
- Provision of Grants (currently a matter not agreed)
 - The Project is proposing a Community Fund and discussions are underway with the Council to secure these funds. However, the Council disagrees with the quantum of the Community Fund.

Current engagement

Changes made as a result of Thurrock Council Feedback

- Developing key documents I.e., outline Traffic Management Plan for Construction, outline Materials Handling Plan & Framework Construction Travel Plan in the first place
- River transport commitment
- Traffic monitoring commitment during construction on key Thurrock roads
- Health monitoring commitment & worker accommodation helpdesk commitment
- SEE targets in Section 106 agreement, full strategy appended to s106
- Provision of the Tilbury operational access
- Refreshed approach to carbon and the Carbon & Energy Management Plan as a secure document with robust commitments.
- VISSIM modelling of key junctions (ongoing)
- Establishment of Pre-construction air quality and noise monitoring equipment in 2021-2022

Current engagement

	Name	Amount	Description
Successful funding bids complete / in delivery	Two Forts Way realignment	£65,000	Works complete. Funding provided to reconnect approximately 1km of shared-user route that forms part of the National Cycle Network between Coalhouse Fort and Tilbury Fort.
	Belhus Park CMP	£50,000	Works complete. Funding provided to create a conservation management plan for Belhus Park; includes 20 year action plan and identifies future restoration funding opportunities.
	Green space enhancements	£100,000	In delivery by Thurrock Council. Funding provided to create masterplans for 6 public parks surrounding Tilbury; King George's Park, Koala Park, Anchor Fields, Fielding Avenue, Orsett Heath and Chadwell Recreation Ground and Wickham Fields.
	Coastal Path improvements	£900,000	Funding approved. To deliver the first phase of the ASELA coastal path project between Coalhouse Fort and Stanford-le-Hope. Improvements to the existing public right of way along the north bank of the Thames, connecting into a number of wildlife sites.
	Additional WCH routes assessments	£196,000	Funding approved. To assess feasibility of 7 wider improvements to the WCH network put forward by Thurrock Council officers.
	Total	£1,311,000	

Current engagement

Thurrock Council – Designated Funds

- **Funding bids in progress**
 - Community Fibre Connectivity
 - Potential extension of Dartford demand responsive transport system to Grays
 - Potential extension of Fastrack bus rapid transit system from Kent to Thurrock
- **Projects subject to ongoing discussion with Thurrock Council officers**
 - Additional WCH routes
 - Mardyke Valley improvements
 - Belhus Park restoration works and Coalhouse Fort condition assessment
- **Other funding being invested to benefit communities in Thurrock**
 - Digital heritage platform
 - Essex and Thurrock heritage display and storage assessment
 - Environmental delivery plans and Habitat restoration

Programme



Progress so far

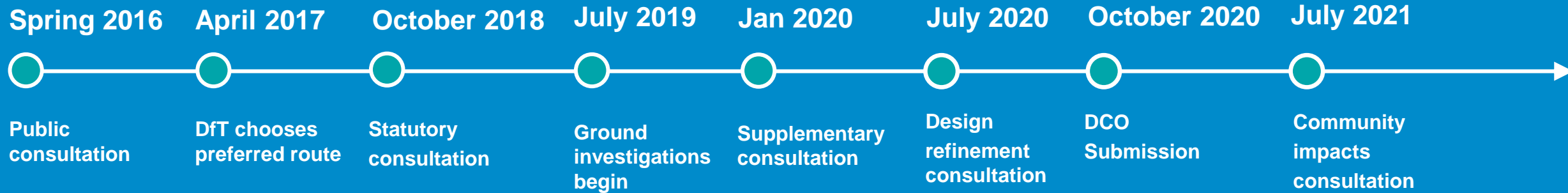

Pre-submission, examination and next steps



An aerial photograph of a wide river winding through a landscape at sunset. The sky is a gradient of orange, yellow, and blue. The river reflects the light from the sun. In the foreground, a city is visible with its lights glowing. The text "Thank you for your time" is overlaid in the center in a white, sans-serif font.

Thank you for your time